

SPASY™

Bone Cement Dispensing Kit

Indication

- VCF (Vertebral compression fracture) due to Osteoporosis
- Osteolytic fracture
- Metastatic bone fractures



• Bone Cement Dispensing Device

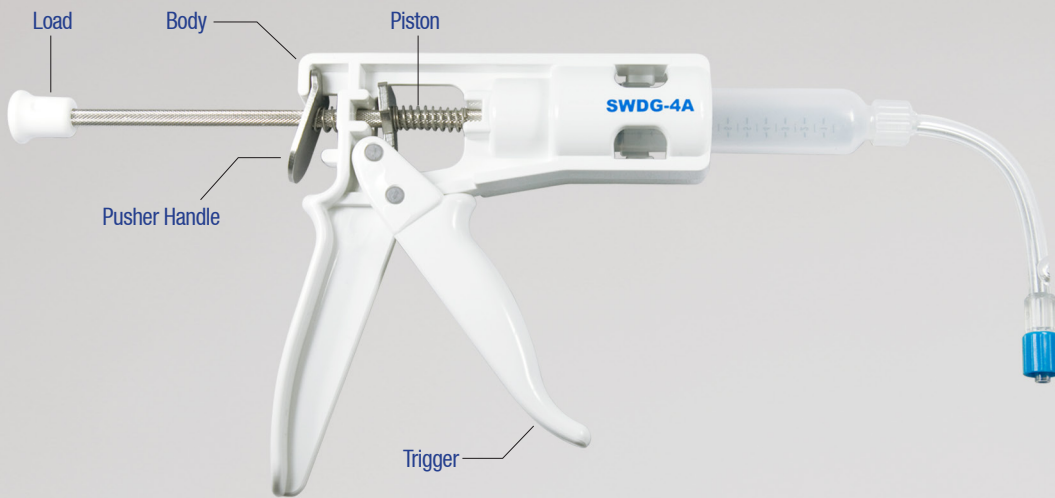

• Bone Marrow Needle

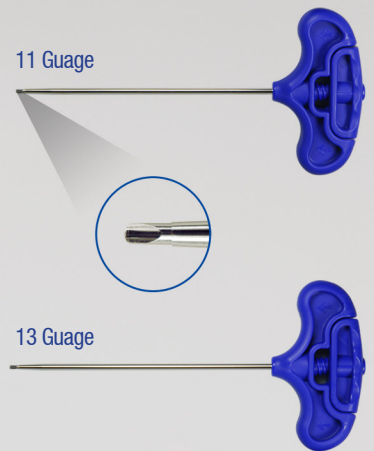

Step-1

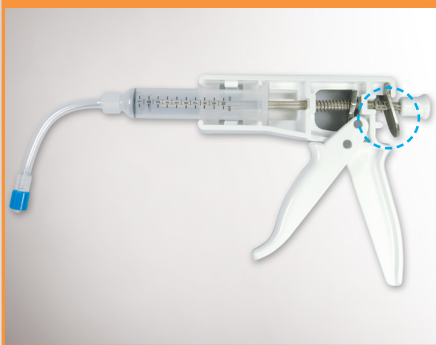

Push the pusher plate and pull out the load to fix the piston in the middle of the body.

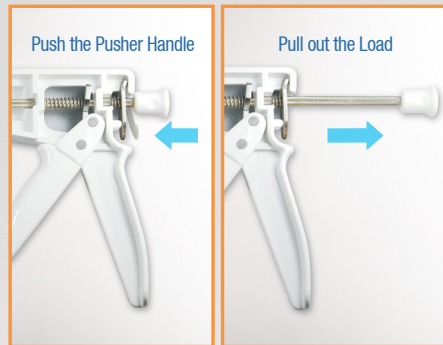

Step-2

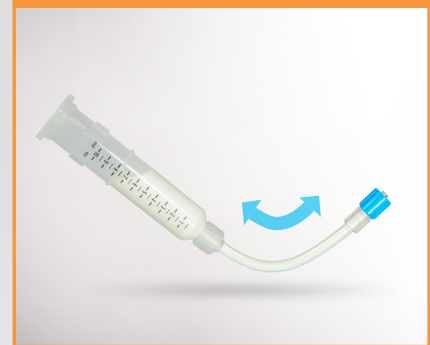

Pour the cement carefully into the syringe leaning to the left side as presented above

Step-3



Turn the syringe to the right till the "Lock sound" is audible. Then, pull the trigger to remove the air inside of the syringe.

Step-4



Assemble the hose to the Bone Marrow Needle. Pull the trigger with the handle slowly to press the piston in the syringe to push the bone cement.

Ordering Information

No	Article Name	Article Name	Device Name	Q'ty
1	SWM-KIT-T4	SWVP-11A	Bone Marrow Needle	2
		SWDG-4A	Bone Cement Dispensing Device	1
2	SWM-KIT-T4-1	SWVP-13A	Bone Marrow Needle	2
		SWDG-4A	Bone Cement Dispensing Device	1
3	SWM-KIT-T4-2	SWVP-11A	Bone Marrow Needle	1
		SWVP-13A	Bone Marrow Needle	1
		SWDG-4A	Bone Cement Dispensing Device	1

Article No	Gauge	Length(mm)
SWVP-11A	11	125
SWVP-13A	13	125